



Motia Aero Greens is an inspirational project that flows with the energy of serenity and calm living. Even though it is located in the center of the buzzing city life, it still promises a peaceful life in the lap of nature.

The strategic location ensures that all amenities are within easy reach. The security and safe environment gives you the peace of mind you have always been looking for.

### HOW TO REACH

**OUR DELIVERED PROJECTS**

- Motia Heights (KAREA, DHAKOLI)
- Motia Plaza (NALAGARHROAD, JABADDHHP.)
- Motia City (CHANDIGARH-AMBALA HIGHWAY, ZIRAKPUR)
- Motia Royal Business Park (CHANDIGARH-AMBALA HIGHWAY, ZIRAKPUR)
- Motia Gill Estate (CHANDIGARH-KURALI HIGHWAY)
- Motia Huys (DHAKOLI, ZIRAKPUR)

**OUR ONGOING PROJECTS**

- Motia Guildford (AIRPORT ROAD, ZIRAKPUR)
- Motia Aero Greens (ADJ. AEROCITY BLOCKS, DAYALPURA, ZIRAKPUR)
- Motia Aero Greens-II (ADJ. AEROCITY BLOCKS, DAYALPURA, ZIRAKPUR)
- Motia Harmony City (NEELJAREH, CHANDIGARH)
- Motia Estate (ADJ. AEROCITY BLOCKS, DAYALPURA, ZIRAKPUR)
- Motia Gill Estate (CHANDIGARH-KURALI HIGHWAY)

**KEY DISTANCES**

- Mohali 10 Mins
- Aerocity 10 Mins
- Bus Stand 07 Mins
- VIP Road 05 Mins
- Harmoni 03 Mins
- Shopping Mall 05 Mins
- International Airport 10 Mins
- MCD, Mohali 05 Mins
- Mohali 10 Mins

**MOTIA GROUP**  
www.motiagroup.com

Site Office: Adj. Aerocity I Block, Dayalpura, Teh. Zirakpur, SAS Nagar, Mohali (Punjab)  
Head Office: Motia Guildford Square, PR7 Airport Road, Zirakpur (Chd.)  
Give a call on **+91 98 75 91 57 74, +91 85 58 84 45 19**  
info@motiagroup.com

SCAN HERE FOR LOCATION

A Project by MOTIA GROUP PBRERA-SAS79-PR0824

# MOTIA AEROGREENS

Today's Investment. Tomorrow's Pride

## LUXURY LIFE INSPIRED BY NATURE.

### 3 BHK LUXURY INDEPENDENT FLOORS

Divine Blessings

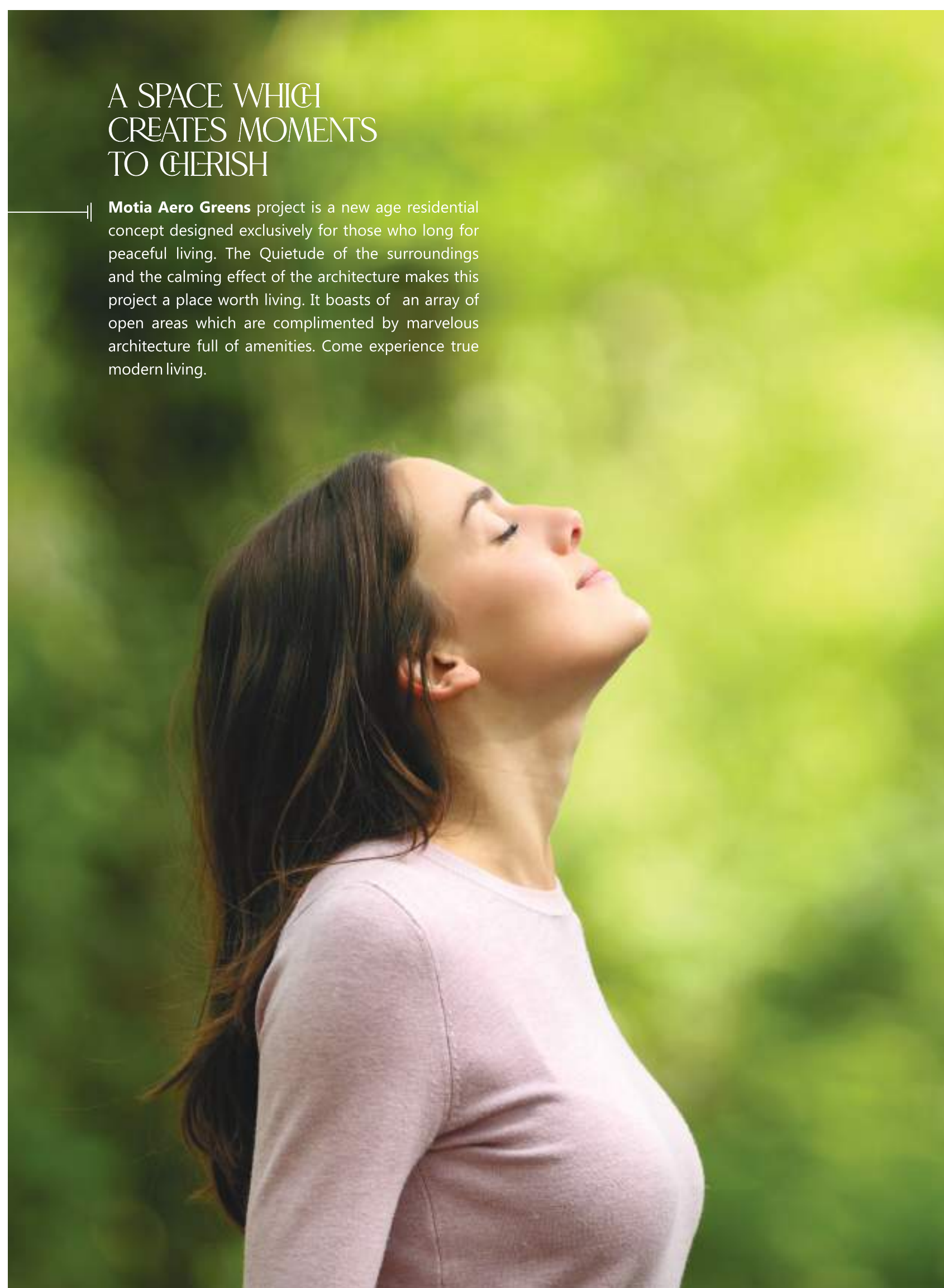
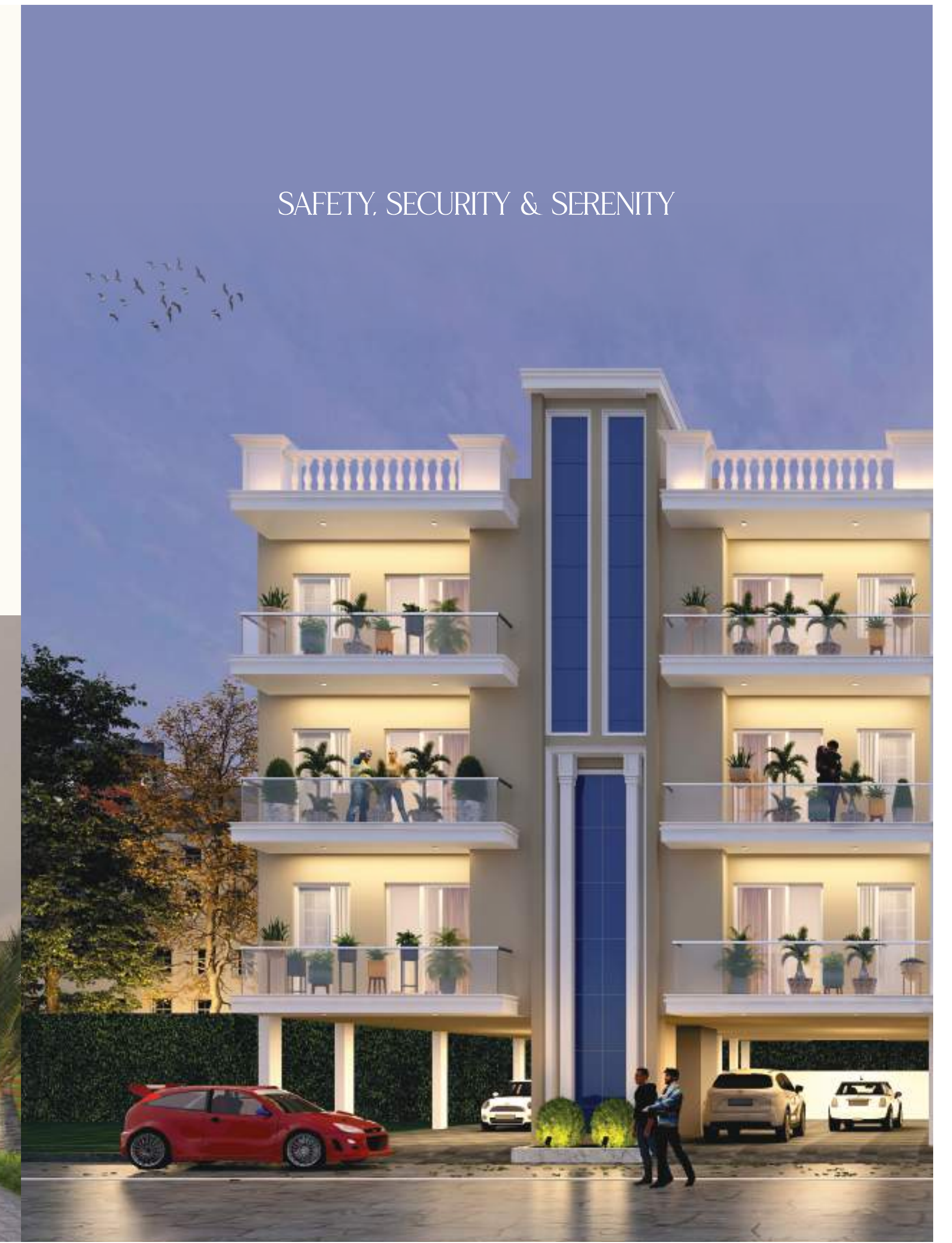

A SPACE WHICH CREATES MOMENTS TO GEMISH

Motia Aero Greens project is a new age residential concept designed exclusively for those who long for peaceful living. The Quietude of the surroundings and the calming effect of the architecture makes this project a place worth living. It boasts of an array of open areas which are complimented by marvelous architecture full of amenities. Come experience true modern living.

### Unit Plan 3 BHK 21' X 69'-3" (Approx 161 sqyd.)

### Unit Plan 3 BHK 22'-3" X 55' (Approx 136 sqyd.)

**MOTIA AEROGREENS**  
Today's Investment. Tomorrow's Pride

All floor plans, Specifications, Artistic, Rendering & Images in the brochure are indicative and are subject to change as decided by the company or by the competent authority in the best interest of the development. Soft furniture, furnishing and gadgets are not part of the offerings.

### SPECIFICATIONS

**MODULAR KITCHEN**

- FLOORING AND SKIRTING ORIENT JOINTLESS (32"X64" BIG SIZE) GRAND ITALIAN LOOK TILES OR EQUIVALENT
- WALL FINISHES PLEASING SHADE OF PAINT ON WALLS AND CERAMIC TILES UPTO 2FT. ABOVE COUNTER
- MODULAR CABINETS SINK DOUBLE BOWL STAINLESS STEEL
- ELECTRICAL CHIMNEY FITTED
- PLATFORM GRANITE COUNTER
- FITTING & FIXTURES JACUAR CP PREMIUM FITTINGS OR EQUIVALENT

**WASHROOMS**

- FLOORING ANTI SKID PREMIUM TILES
- WALLS CERAMIC TILES UPTO DOOR HEIGHT
- FITTINGS & FIXTURES JACUAR CP FITTINGS & CHINAWARE OR EQUIVALENT
- PLUMBING PIPES SUPREME (BEST IN SEGMENT) OR EQUIVALENT
- CONCEALED TANK GEBERIT OR EQUIVALENT

**ELECTRICAL**

- CONCEALED CONDUITS FIREPROOF WIRING WITH COPPER CONDUCTORS.
- MODULAR GOLDMEDAL SWITCHES
- FRLS GOLDMEDAL WIRES OR EQUIVALENT (FIRE RESISTANT LOW SMOKE)

**LIVING/DINING ROOM**

- FLOORING AND SKIRTING ORIENT JOINTLESS (32"X64" BIG SIZE) GRAND ITALIAN LOOK TILES OR EQUIVALENT
- WALL FINISHES PLEASING SHADE OF PREMIUM PAINT ON WALLS

**BEDROOMS**

- FLOORING AND SKIRTING ORIENT JOINTLESS (32"X64" BIG SIZE) GRAND ITALIAN LOOK TILES OR EQUIVALENT
- WALL FINISHES, CEILING PLEASING SHADE OF PAINT ON WALLS
- PROVISION FOR AC
- FITTINGS & FIXTURES SPACIOUS MODULAR WARDROBE
- POP CEILING WITH LED LIGHTS

**DOORS AND WINDOWS**

- INTERNAL DOORS HIGH QUALITY FLUSH DOORS WITH PREMIUM MICA FINISH
- EXTERNAL DOORS & WINDOWS PREMIUM ALUMINIUM SLIDING DOORS & WINDOWS

**BALCONY**

- GLASS RAILING
- FLOORING, SKIRTING CERAMIC TILES ANTI SKID
- WALL FINISHES, CEILING ALL THE SURFACE OF WALL & CEILINGS SHALL BE FINISHED IN PLEASING SHADES & COMBINATION OF LONG LASTING WATER REPELLENT PAINT

All floor plans, Specifications, Artistic, Rendering & Images in the brochure are indicative and are subject to change as decided by the company or by the competent authority in the best interest of the development. Soft furniture, furnishing and gadgets are not part of the offerings.

### AMENITIES

- Centralized Location
- Lush Green Surroundings
- Rain Water Harvesting
- Outdoor Gym
- 100% Power Backup for Common Amenities
- Ample/Spacious Stilt Parking
- 24x7 CCTV Surveillance
- Beautiful Landscaped Parks
- Spacious Lift
- Fenced and Gated Residential Society
- RCC Earthquake Resistant
- Front & Back Open Flats
- Single Entry Exit